

ELECTRO - MAGNETIC NORMALLY ' OFF ' TYPE BRAKE

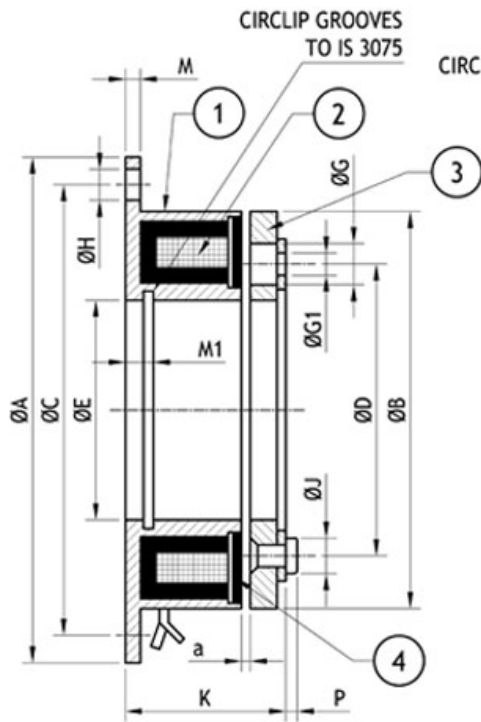

DESIGN 1.1

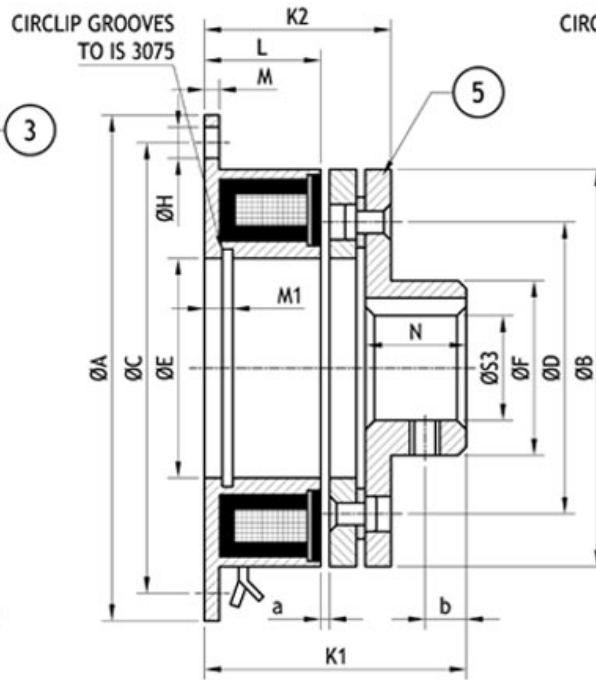

DESIGN 2.1

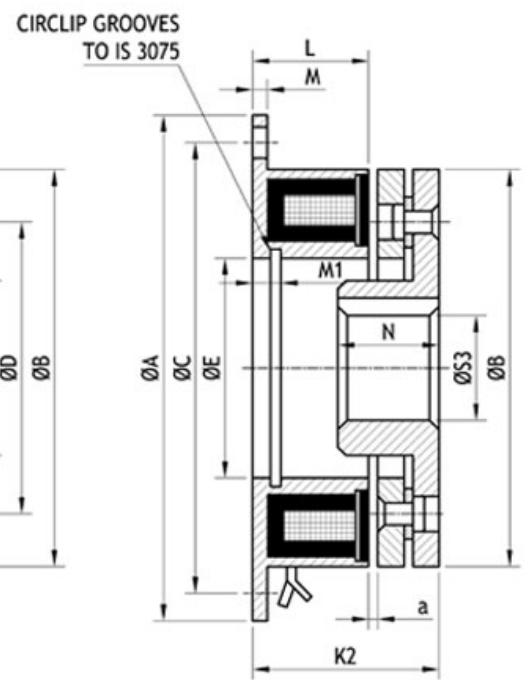

DESIGN 4.1

MODEL :	P 63	P 80	P 100	P 125	P 160	P 200	P 250
TORQUE (NM)	7	14	28	55	110	220	440
MAX. SPEED (RPM)	7500	6500	5500	4500	4500	3000	2000
INPUT POWER (W) AT 20°C CLUTCH	12	16	20	26	36	46	60
Ø A h8	80	100	125	150	190	230	290
Ø B h8	63	80	100	125	160	200	250
Ø C	72	90	112	137	175	215	270
Ø D	46	60	76	95	120	158	210
Ø E H8	35	42	52	62	80	100	125
Ø F	28	33	43	50	66	84	106
Ø G	6.3	8	10.5	12	15	18	22
Ø G 1	3 x 3.1	3 x 4.1	3 x 5.1	3 x 6.1	3 x 8.2	3 x 10.2	4 x 12.2
Ø H	4 x 4.5	4 x 5.5	4 x 6.6	4 x 6.6	4 x 9	4 x 9	4 x 11
Ø J	3 x 5.5	3 x 7	3 x 9	3 x 10	3 x 13	3 x 16	4 x 20
K	22	24.5	27.9	31	35	41.4	47.9
K 1	37	44.5	52.9	61	73	89.4	102.9
K 2	25.5	28.5	32.9	37	42	50.4	58.9
L	18	20	22	24	26	30	35
M	2	2.5	3	3.5	4	5	6
M 1	3.5	4.3	5	5.5	6	7	8
N	15	20	25	30	38	48	55
P	1.6	1.8	2.4	2.8	3.2	4	4.3
a	0.2	0.2	0.2	0.3	0.3	0.5	0.5
b	5	6	6	10	10	15	20
MAX. BORE Ø S3 H7	17	20	30	35	40	60	80

PARTLIST

1. BRAKE MAGNET BODY.
2. BRAKE COIL.
3. ARMATURE PLATE.
4. FRICTION LINER.
5. ARMATURE PLATE WITH BACK PLATE.

ALL DIMENSIONS ARE IN MM.
ALTERNATIONS RESERVED.

STANDARD BORES : 11,14,19,20,24,
28,32,34,38,42,48,55,60,70

STANDARD VOLTAGES : 24 VDC, 96
VDC, 190 VDC.

LEAD WIRE LENGTH = 400 MM

1 Nm = 0.102 Kgm = 0.737 lb. ft.